



PETROL ENGINE WATER PUMP UNIT
OWNER'S MANUAL
MODEL:HD3XH



CONTENTS

- SAFETY..... 1
- BEFORE STARTING..... 2
- START ENGINE..... 3-4
- STOP ENGINE..... 3-4
- MAINTENANCE..... 5
- TROUBLE SHOOTING..... 7
- WATER PUMP EXPLODED VIEW..... 8
- WATER PUMP PARTS LIST..... 9
- GASOLINE ENGINE EXPLODED VIEW..... 10
- GASOLINE ENGINE PARTS LIST..... 11-12

SAFETY

BE CAREFUL!

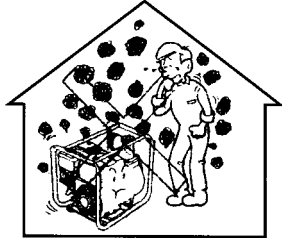

NO USE IN HOUSE

KEEP IN FLAMMABLE
GOOD AWAY

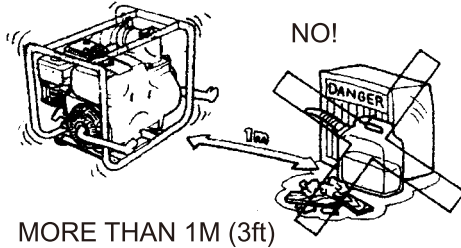

MORE THAN 1M (3ft)

WHEN REFUELING:

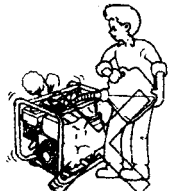

STOP ENGINE!



NO SMOKING!

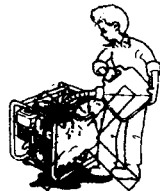

DO NOT SPILL!

BEFORE STARTING

1 CONNECT HOSE

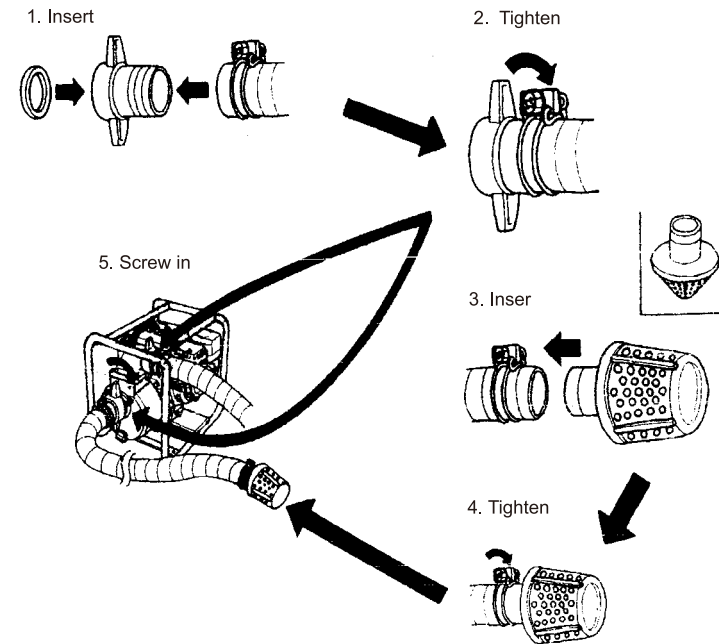

2 FILL PRIMING WATER

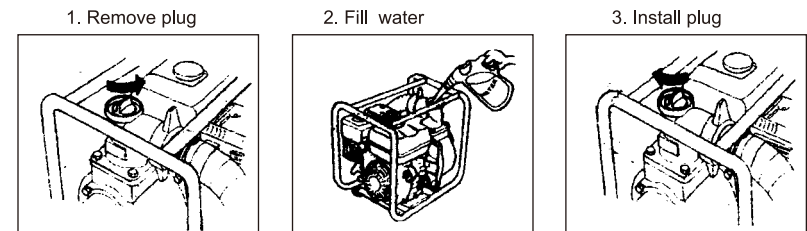

START ENGINE

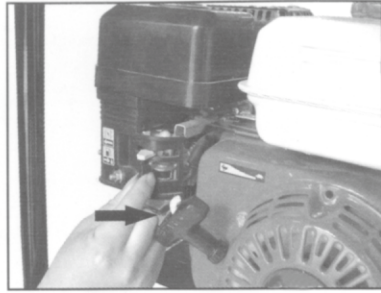

Open the oil valve onto on position

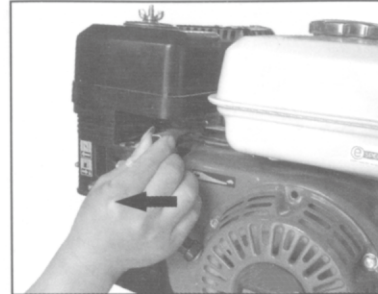

Put the throttle valve to half position



Switch the air shutter onto close position



Put the Engine switch onto on position

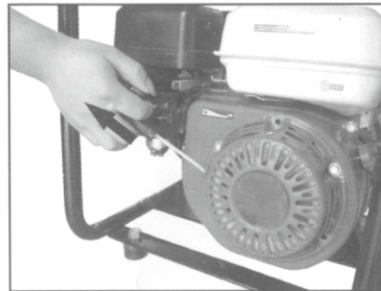

Pull it handle of the string slowly till resistance force is felt then pull it with force and at a high speed.(Note:it should be released slowly along the recoil force.)

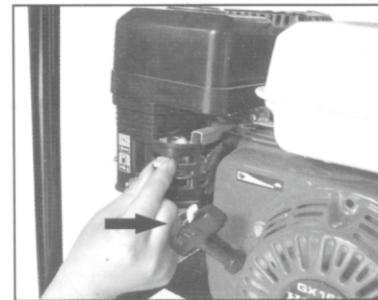

Switch the air shutter onto on position

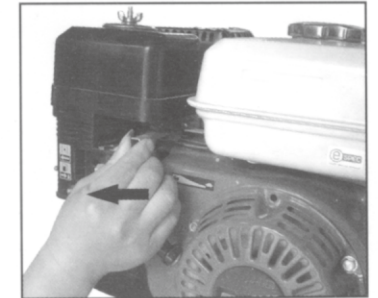

Raise the oil valve

STOP ENGINE

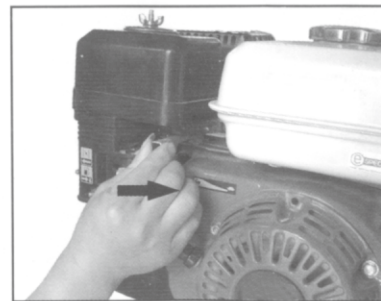

Turn off the oil valve



Turn off the oil valve

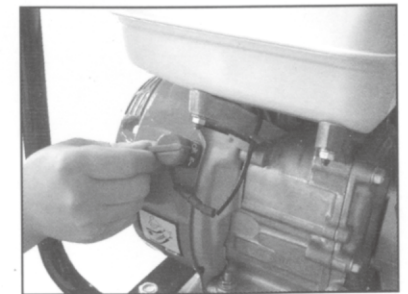

Put the Engine switch onto off position

MAINTENANCE

CHECK OIL EVERY OPERATION

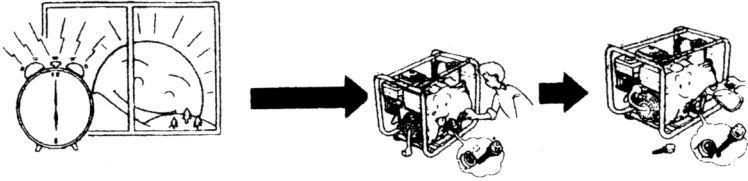

SAE 10W 30 OR
EQUIVALENT MOTOR OIL
SAE 10W-30

CHANGE THE OIL AFTER THE
FIRST MONTH OR AFTER 20
HOURS, WHICHEVER COMES
FIRST. AFTER THIS CHANGE
THE OIL EVERY 6 MONTHS OR
100 HOURS, WHICHEVER COMES
FIRST.

DRAIN

FILL 0.6L

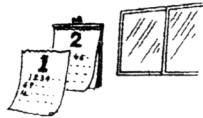
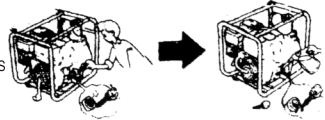

SPARK PLUG

NO GOOD CONDITION

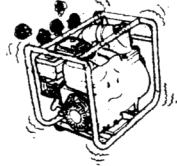

REMOVE PLUG

CLEAN

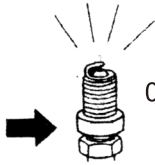
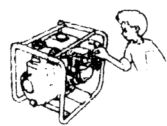

0.7-0.8mm

MAINTENANCE

AIR CLEANER

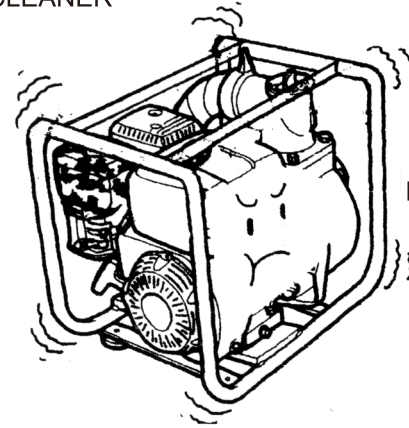

NO GOOD CONDITION

WASH → DRY



KEROSENE

SOAK → SQUEEZE



ENGINE OIL

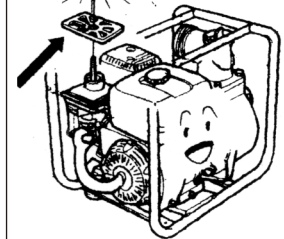
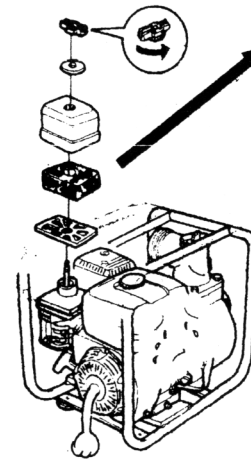

TROUBLE SHOOTING

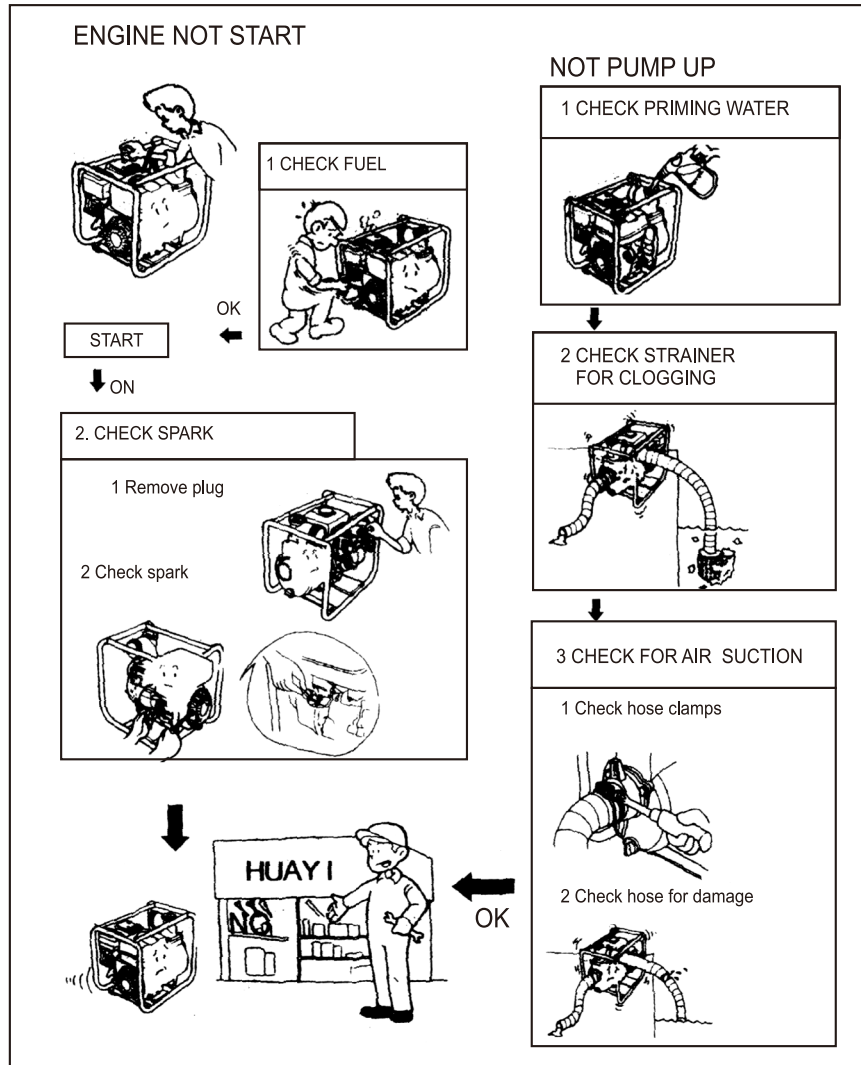

Model HD3XH

PARTS LIST GASOLINE WATER PUMP-1

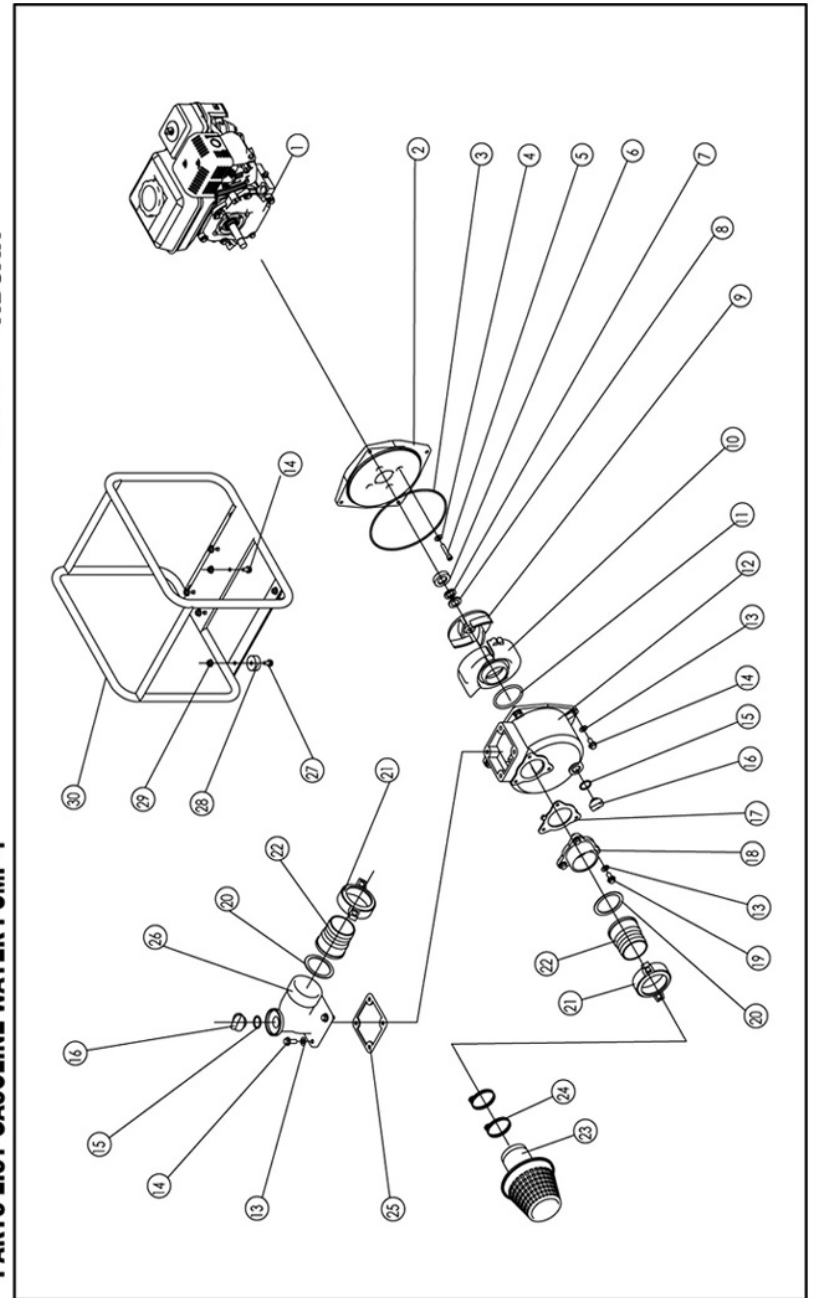



HONDA Engine Parts List

Model HD3XH

REF. NO.	PART NO.			DESCRIPTION	QTY.
	Model HD3XH	Model HD3XH	Model HD3XH		
1	160F-I-001	*	*	Fuel hose clip	2
2	160F-I-002	*	*	Fuel hose	1
3	160F-I-003	*	*	Fuel outlet joint	1
4	160F-I-004	*	*	Fuel tank cap	1
5	160F-I-005	*	*	Fuel filter	1
6	160F-I-006	*	*	Fuel tank	1
7	160F-I-007	*	*	Carburetor spring	1
8	160F-I-008	*	*	Governing spring	1
9	160F-I-009	*	*	Governor arm	1
10				Nut M6	5
11	160F-I-010	*	*	Clip	1
12	160F-I-011	*	*	Governor shaft	1
13	160F-I-012	*	*	Carburetor connecting rod	1
14				Screw M6x12	13
15	160F-I-013	*	*	Governor arm screw	1
16	160F-I-014	*	*	Throttle control rack	1
17	160F-I-015	*	*	Governor shaft washer	2
18	160F-I-016	*	*	Rope handle	1
19	160F-I-017	*	*	Starter case	1
20	160F-I-018	*	*	Starter spring	1
21	160F-I-019	*	*	Rope	1
22	160F-I-020	*	*	Drum sheave	1
23	160F-I-021	*	*	Spring	2
24	160F-I-022	*	*	Drive pawl	2
25	160F-I-023	*	*	Pawl guide	1
26	160F-I-024	*	*	Setting screw	1
27	160F-I-025	*	*	Engine switch	1
28	160F-I-026	*	*	Fan case	1
29	160F-I-027	*	*	Flywheel nut M14	1
30	160F-I-028	*	*	Starting hub	1
31	160F-I-029	*	*	Cooling fan	1
32	160F-I-030	*	*	Flywheel	1
33	160F-I-031	*	*	Air shroud	1
34	160F-I-032	*	*	Oil seal 22x41.3x6	2
35	160F-I-033	*	*	Diode rack	1
36	160F-I-034	*	*	Diode	1
37	160F-I-035	*	*	Drain plug	2
38	160F-I-036	*	*	Drain plug washer	2
39	160F-I-037	160F-II-001	170F-001	Crankcase	1
40	160F-I-038	*	*	Ball bearing	2
41	160F-I-039	*	*	Oil level sensor	1
42	160F-I-040	*	*	Governing gear	1
43	160F-I-041	*	*	Flyweight pin	2
44	160F-I-042	*	*	Governing gear shaft	1
45	160F-I-043	*	*	Governing gear shaft circlip	1
46	160F-I-044	*	*	Flyweight	2
47	160F-I-045	*	*	Washer	1
48	160F-I-046	*	*	Collar	1
49	160F-I-047	160F-II-002	**	Crankshaft assembly	1
50	160F-I-048	*	*	Crankcase gasket	1
51	160F-I-049	*	*	Oil gauge	1
52	160F-I-050	*	*	Oil gauge seal	2
53	160F-I-051	*	*	Crankcase cover	1
54	160F-I-052	*	*	Screw M8x32	6

* The part number same as Model 160F-I ** The part number same as Model 160F-II

Please provide following information for ordering parts and maintenance:

. Model number

. Part description,reference and part number as shown in parts list



HONDA Engine Parts List

Model HD3XH

REF. NO.	PART NO.			DESCRIPTION	QTY.
	Model HD3XH	Model HD3XH	Model HD3XH		
55				Screw M6x8	5
56	160F-I-053	*	*	Air cleaner cover nut	1
57	160F-I-054	*	*	Washer	1
58	160F-I-055	*	*	Gasket	1
59	160F-I-056	*	*	Air cleaner cover	1
60	160F-I-057	*	*	Air cleaner element	1
61	160F-I-058	*	*	Element rack	1
62	160F-I-059	*	*	Air cleaner housing	1
63				Screw M6x25	3
64	160F-I-060	*	*	T. C. I. Unit	1
65	160F-I-061	*	*	Dowel pin	2
66				Cylinder screw M8x55	4
67	160F-I-062	*	*	Carburetor washer	1
68	160F-I-063	*	*	Choke level	1
69	160F-I-064	160F-II-003	**	Carburetor	1
70	160F-I-065	*	*	Carburetor gasket	1
71	160F-I-066	*	*	Carburetor connector	1
72	160F-I-067	*	*	Connector gasket	1
73	160F-I-068	*	*	Carburetor bolt M6x113	2
74	160F-I-069	*	*	Breather tube	1
75	160F-I-070	*	*	Cylinder head cover	1
76	160F-I-071	*	*	Cylinder head cover gasket	1
77	160F-I-072	*	*	Exhaust valve cap	1
78	160F-I-073	*	*	Intake valve retainer	1
79	160F-I-074	*	*	Exhaust valve Retainer	1
80	160F-I-075	*	*	Valve spring	2
81	160F-I-076	*	*	Spark plug	1
82	160F-I-077	160F-II-004	**	Cylinder head	1
83	160F-I-078	160F-II-005	170F-002	Cylinder gasket	1
84	160F-I-079	*	*	Intake valve	1
85	160F-I-080	*	*	Exhaust valve	1
86	160F-I-081	*	*	Valve lifter	2
87	160F-I-082	160F-II-006	**	Camshaft assembly	1
88	160F-I-083	*	*	Dowel pin	2
89	160F-I-084	*	*	Valve clearance adjusting nut	2
90	160F-I-085	*	*	Rocker arm seat	2
91	160F-I-086	*	*	Rocker arm	2
92	160F-I-087	*	*	Rocker arm bolt	2
93	160F-I-089	*	*	Push rod guide	1
94	160F-I-090	*	*	Push rod	2
95	160F-I-091	*	*	Crankshaft key	1
96	160F-I-092	*	*	Screw M5x8	4
97	160F-I-093	*	*	Muffler protector	1
98	160F-I-094	*	*	Muffler	1
99	160F-I-095	*	*	Nut M8	2
100	160F-I-096	*	*	Exhaust gasket	1
101	160F-I-097	*	*	Exhaust bolt	2
102	160F-I-098	*	*	Air shroud	1
103	160F-I-099	*	170F-003	Piston ring set	1
104	160F-I-100	160F-II-007	170F-004	Piston	1
105	160F-I-101	*	*	Piston pin circlip	2
106	160F-I-102	*	170F-005	Piston pin	1
107	160F-I-103	*	*	Connecting rod assembly	1
108	160F-I-104	*	*	Oil filling plug	1

* The part number same as Model 160F-I ** The part number same as Model 160F-II

Please provide following information for ordering parts and maintenance :

. Model number

. Part description ,reference and part number as shown in parts list